



## Alcohol and Entertainment Licensing Sub-Committee

**Thursday 5 January 2023 at 10.00 am**

This will be held as an online virtual Meeting

Details on how to access the link in order to view the meeting will be made available online via the following link: [HERE](#)

### Membership:

#### Members

Councillors:

Ahmed (Chair)  
Long (Vice-Chair)  
Mahmood

#### Substitute Members

Councillors:

Bajwa, Chappell, Chohan, Georgiou, Collymore,  
Ethapemi, Rubin

**For further information contact:** Devbai Bhanji, Governance Assistant  
Tel: 020 8937 6841; Email: [devbai.bhanji@brent.gov.uk](mailto:devbai.bhanji@brent.gov.uk)

For electronic copies of minutes, reports and agendas, and to be alerted when the minutes of this meeting have been published visit:

[www.brent.gov.uk/committees](http://www.brent.gov.uk/committees)

**The press and public are welcome to attend this meeting as an online virtual meeting. The link to view the meeting will be made available via the following link: [HERE](#)**

## **Notes for Members - Declarations of Interest:**

If a Member is aware they have a Disclosable Pecuniary Interest\* in an item of business, they must declare its existence and nature at the start of the meeting or when it becomes apparent and must leave the room without participating in discussion of the item.

If a Member is aware they have a Personal Interest\*\* in an item of business, they must declare its existence and nature at the start of the meeting or when it becomes apparent.

If the Personal Interest is also significant enough to affect your judgement of a public interest and either it affects a financial position or relates to a regulatory matter then after disclosing the interest to the meeting the Member must leave the room without participating in discussion of the item, except that they may first make representations, answer questions or give evidence relating to the matter, provided that the public are allowed to attend the meeting for those purposes.

### **\*Disclosable Pecuniary Interests:**

- (a) **Employment, etc.** - Any employment, office, trade, profession or vocation carried on for profit gain.
- (b) **Sponsorship** - Any payment or other financial benefit in respect of expenses in carrying out duties as a member, or of election; including from a trade union.
- (c) **Contracts** - Any current contract for goods, services or works, between the Councillors or their partner (or a body in which one has a beneficial interest) and the council.
- (d) **Land** - Any beneficial interest in land which is within the council's area.
- (e) **Licences**- Any licence to occupy land in the council's area for a month or longer.
- (f) **Corporate tenancies** - Any tenancy between the council and a body in which the Councillor or their partner have a beneficial interest.
- (g) **Securities** - Any beneficial interest in securities of a body which has a place of business or land in the council's area, if the total nominal value of the securities exceeds £25,000 or one hundredth of the total issued share capital of that body or of any one class of its issued share capital.

### **\*\*Personal Interests:**

The business relates to or affects:

- (a) Anybody of which you are a member or in a position of general control or management, and:
  - To which you are appointed by the council;
  - which exercises functions of a public nature;
  - which is directed is to charitable purposes;
  - whose principal purposes include the influence of public opinion or policy (including a political party or trade union).
- (b) The interests a of a person from whom you have received gifts or hospitality of at least £50 as a member in the municipal year;

or

A decision in relation to that business might reasonably be regarded as affecting the well-being or financial position of:

- You yourself;
- a member of your family or your friend or any person with whom you have a close association or any person or body who is the subject of a registrable personal interest.

# Agenda

Introductions, if appropriate.

Item	Page
<b>1 Apologies for absence and clarification of alternate members</b>	
<b>2 Declarations of Interests</b>	
Members are invited to declare at this stage of the meeting, the nature and existence of any relevant disclosable pecuniary or personal interests in the items on this agenda and to specify the item(s) to which they relate.	
<b>3 Application for the Review a Premises Licence by a Local Resident for the premises known as The Kilburn Arms, 97-101 Willesden Lane, NW6 7SD, pursuant to the provisions of the Licensing Act 2003</b>	1 - 64

**Date of the next meeting:            Date Not Specified**



- Please remember to **SWITCH OFF** your mobile phone during the meeting.
- The meeting room is accessible by lift and seats will be provided for members of the public.

This page is intentionally left blank

## LICENSING ACT 2003

### Application for the Review a Premises Licence

Name of Applicant:	A Local Resident
Name & Address of Premises:	The Kilburn Arms, 97-101 Willesden Lane, NW6 7SD
Applicants Agent:	

#### 1. Application

The application is for the review of a premises licence held by Beronmoor Ltd. The premises are known as The Kilburn Arms, 97-101 Willesden Lane, NW6 7SD.

#### 2. Grounds for Review

The grounds for review are the Prevention of Public Nuisance.

The premises is causing a nuisance to residents impacting negatively on their lives.

#### 3. Relevant Representations

Representation has been received from local residents, the Licensing Enforcement Officer and Nuisance Control Officer.

#### 4. Background

These premises are currently licensed for Regulated Entertainment from 8.00pm to midnight Sunday to Thursday and to 1.00am Friday & Saturday, Late Night Refreshment from 23.00pm to 1.00am Monday to Thursday and 2.00am Friday to Sunday, the sale of alcohol from 10.00am to 2.00am Monday to Sunday and to remain open from 10.00am to 2.30am Monday to Sunday.

The Designated Premises Supervisor is Mr Constantin Tofan.

The steps the Committee may take are:

- To modify, remove or add conditions
- To exclude the sale of alcohol or other licensable activity
- Remove the Designated Premises Supervisor
- Suspend the licence for up to 3 months.
- Revoke the licence

#### 5. Associated Papers

- A. Review Application
- B. Resident Reps

- C. Licensing Rep
- D. NCT Rep
- E. Current Licence
- F. OS Map



# APPLICATION FOR A REVIEW OF A PREMISES LICENCE OR CLUB PREMISES CERTIFICATE

Application for the review of a premises licence or club premises certificate under the Licensing Act 2003

## PLEASE READ THE FOLLOWING INSTRUCTIONS FIRST

Before completing this form please read the guidance notes at the end of the form. If you are completing this form by hand please write legibly in **block capitals**. In all cases ensure that your answers are inside the boxes and written in **black ink**. Use additional sheets if necessary. You may wish to keep a copy of the completed form for your records.

I **[REDACTED]** apply for the review of a premises licence under section 51 of the Licensing Act 2003 for the premises described in Part 1 below (delete as applicable).

### Part 1 – Premises or club premises details

Name and postal address of premises or, if none, ordnance survey map reference or description	
99-101 Willesden Ln, London NW6 7SD	
Post Town LONDON	Post Code NW67SD
Name of premises licence holder or club holding club premises certificate (if known)	
Number of premises licence or club premises certificate (if known)	





## Part 2 - Applicant details

- I am
- Please tick ✓ Yes
- 1) An individual, body or business which is not a responsible authority  
(Please read guidance note 1 and complete (A) or (B) below)
- 2) a responsible authority (please complete (C) below)
- 3) a member of the club to which this application relates (please complete (A) below)

### (A) DETAILS OF INDIVIDUAL APPLICANT (fill in as applicable)

Please tick

Mr

Mrs

Miss

Ms

Other title   
(for example, Rev)

Surname

First names

Please tick ✓ Yes

I am 18 years old or over



Current postal  
address  
if different from  
premises address

Post Town

LONDON

Postcode

Daytime contact telephone number

E-mail address (optional)

### (B) DETAILS OF OTHER APPLICANT

Name and address
Telephone number (if any)
E-mail address (optional)

**(C) DETAILS OF RESPONSIBLE AUTHORITY APPLICANT**

Name and address
Telephone number (if any)
E-mail address (optional)

**This application to review relates to the following licensing objective(s)**

Please tick one or more boxes

- 1) the prevention of crime and disorder
- 2) public safety
- 3) the prevention of public nuisance
- 4) the protection of children from harm

- 
- 
- 
- 

**Please state the ground(s) for review** (please read guidance note 2)

As residents whose house is not only within proximity, but in fact attached to the Kilburn Arms. The noise and vibrations transmit through the walls into our bedroom and kitchen.

We wish to contest the current license of the Kilburn Arms under the "prevention of public nuisance".

The grounds for review are based on a number of offences since the Kilburn Arms has had live bands on every Wednesday and Saturday Nights as well as the occasional Friday nights which has been persistent since March 2022.

We understand that their license has been in place prior to when we purchased our home off of Brent Council in 2012.

**Please provide as much information as possible to support the application** (please read guidance note 3)

**SITUATION :**

Our case has been ongoing since March 2022 with regards to noise and public nuisance. The issue has deteriorated despite the weather being colder.

Our first meeting with the Kilburn Arms was on the **17<sup>th</sup> May 2022** and also where we negotiated the following:

- all doors to the pub should be closed once the music starts at 8pm
- the back terrace must be closed at 10pm
- the duration should be between 8pm and 11pm with the last song played at 10.55pm
- that they seek ways to soundproof the venue

Following visits/communication with The Kilburn Arms, have been:

- 19<sup>th</sup> July 2022 – Letter sent from the residents to The Kilburn Arms
- 7<sup>th</sup> June 2022 – ██████████ Brent Noise team emailed and visited the Kilburn Arms
- 12<sup>th</sup> October 2022 residents met with the on-duty manager
- 28<sup>th</sup> August 2022 residents met with Costas

**ISSUES :**

We have kept a noise diary (attached) and regular noise recordings via the NoiseApp. As you can see the dates and times are consistent with times of the music playing regularly running over the 11pm cut off. Furthermore, the noise and disturbance from the terraces, often running into the early hours of the morning. The recent planning application for the front and back terrace has now impacted our peace and quiet in our own home. As residents with two young children, we noticed that they are quite anxious and restless on Wednesday and Saturday nights. The music and sound from the Kilburn Arms premises cause our children to wake from their sleep on these evenings. This has a knock-on effect on our sleep and as a result our whole family suffer on Thursdays and Sundays!

Because some weeks the situation has been so unbearable, we have felt compelled to get out of the comfort of bed to go round the Kilburn Arms in pajamas after 11pm as the music is still going on, with doors wide open and in full swing with no sign of stopping! Once the live music ends, recorded music is played through speakers onto the decking. Evidence can be seen on the noise diary and videos can also be submitted.

The first occasion on going round to the Kilburn Arms past 11pm, we were met with sincere apologies from the manager however on every occasion after this, we have been quickly dismissed, with the on-duty staff showing a reluctance to stop the music and the conversations have been confrontational making us feel intimidated. We had to call the police as one of the punters from the pub was aggressive and followed my husband to the door of our home.

Police ref numbers are : **82201022** and **PWN-15938-22-0101-B20**

The following mornings (Thursdays and Sundays), we clear up broken glass from our entrance to our house and during the summer months when the weather was hot, hose down the doorway as it smells of urine!

It is also apparent that there is a strong smell of marijuana which we can now smell on

Wednesday and Saturday nights coming from the terraces (front and back).

### **CONCLUSION :**

As a result of the actions of the pub, we are unable to enjoy peace in our own home and feel intimidated on busier nights. Their irresponsible actions are disturbing our young children, creating a state of fear and panic in the early hours of the morning which comes from the pub every Wednesday and Saturday which is negatively impacting our lives and fashioning an unhealthy environment.

What we would like to make clear is that we DO NOT want to end live music for the Kilburn Arms however we would like to see them cooperate with us and police it effectively.

We would like to see the following implemented:

- The Kilburn Arms should NOT be required to stage performances of live music, or the playing of recorded music from **Sunday to Friday (AM and PM)**.
- Live music, or the playing of recorded music should be permitted only on **Saturday evenings** from **8pm to 11pm**. (Band warmups should also be conducted within this time frame)
- All outdoor seating/space should be closed **at 9pm every day** throughout the year. This means people who drink at the pub outdoors should not be congregating on the terrace past 11pm. From what I have observed, other pubs in the local area stop live music and last orders are at 10.30-10.45pm and everyone must disperse by 11.15pm.
- The doors to the Kilburn Arms should always closed when the music is played. Please note the front doors leading onto Willesden Lane should be double closed, not just the internal doors.
- The back doors to the back terrace should always be closed when live music, or recorded music is played. Please see pictures showing the doors being left open and also kept open with wire! (A video can also be provided of doors wide open when music is played).





Please tick ✓ **Yes**

Have you made an application for review relating to this premises before?

If yes, please state the date of that application

Day

Month

Year

--	--	--	--	--	--	--	--

**If you have made representations relating to this premises before, please state what they were and when you made them**

**Checklist**

Please tick ✓ Yes

- I have sent copies of this form and enclosures to the responsible authorities and the premises licence holder or club holding the club premises certificate, as appropriate
- I understand that if I do not comply with the above requirements my application will be rejected



**IT IS AN OFFENCE, UNDER SECTION 158 OF THE LICENSING ACT 2003, TO MAKE A FALSE STATEMENT IN OR IN CONNECTION WITH THIS APPLICATION. THOSE WHO MAKE A FALSE STATEMENT MAY BE LIABLE ON SUMMARY CONVICTION TO A FINE OF ANY AMOUNT.**





**Part 3 – Signatures** (please read guidance note 4)

**Signature of applicant or applicant’s solicitor or other duly authorised agent** (see guidance note 5). **If signing on behalf of the applicant please state in what capacity.**

Signature ..... 

Date ..... 9<sup>th</sup> NOVEMBER 2022

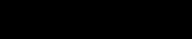
Capacity ..... RESIDENT

<b>Contact name (where not previously given) and postal address for correspondence associated with this application</b> (please read guidance note 6)	
	
<b>Post town</b>	<b>Post code</b>
	
<b>Telephone number</b>	
	
<b>If you would prefer us to correspond with you by e-mail your e-mail address (optional)</b>	
	

**Data Protection:** The London Borough of Brent will use this information for the purposes of The Licensing Act 2003 and related purposes. Any member of the public may examine the application form on request. Further information can be found at [www.brent.gov.uk/privacy](http://www.brent.gov.uk/privacy)

You are providing your information to Brent Council, contact details [business.licence@brent.gov.uk](mailto:business.licence@brent.gov.uk). The Council’s Data Protection Officer can be contacted via [dpo@brent.gov.uk](mailto:dpo@brent.gov.uk), or 020 8937 1402. Your information is collected for the purpose of processing your licence application as required to fulfil the council’s duties under the following legislation, statutory or contractual requirement or obligation.

**Legislation**  
Licensing Act 2003

**Context**  
For the processing of licensing applications and the prevention of fraud



The information may be shared with the Metropolitan Police, London Fire Brigade and teams within Brent Council, as statutory consultees, the Home Office to ascertain the right to work and HM Revenue and Customs, at their request, to identify potential fraud. The information shall be retained until the licence is surrendered and shall be processed in adherence to your legal rights, including but not limited to the right to withdraw consent, right to copies of your information and right to be forgotten. You have a right to lodge a complaint with the Information Commissioner's Office ([www.ico.org.uk](http://www.ico.org.uk))

## Notes for Guidance

1. A responsible authority includes the local police, fire and rescue authority and other statutory bodies which exercise specific functions in the local area.
2. The ground(s) for review must be based on one of the licensing objectives.
3. Please list any additional information or details for example dates of problems which are included in the grounds for review if available.
4. The application form must be signed.
5. An applicant's agent (for example solicitor) may sign the form on their behalf provided that they have actual authority to do so.
6. This is the address which we shall use to correspond with you about this application.

**Please return the completed form and any accompanying documents to the following address with a copy to the premises licence holder / Club that the application relates to:-**

Licensing Department  
Brent Council  
Brent Civic Centre  
Engineers Way  
Wembley  
HA9 0FJ

☎ 020 8937 5359

Email: [business.licence@brent.gov.uk](mailto:business.licence@brent.gov.uk)

**Please follow the instructions in the checklist to submit the relevant copies to the responsible authorities. Contact details shown below:**

Chief Officer of Police  
Brent Licensing Department  
Fifth Floor  
Brent Civic Centre  
Engineers Way  
Wembley  
HA9 0FJ

Tel: 020 8733 3206

North West Area 1  
London Fire Brigade  
169 Union Street  
London  
SE1 0LL

Tel: 020 8555 1200 x38778

Trading Standards  
Fifth Floor  
Brent Civic Centre  
Engineers Way  
Wembley  
HA9 0FJ

Tel: 020 8937 5555

Environmental Health  
Fifth Floor  
Brent Civic Centre  
Engineers Way  
Wembley  
HA9 0FJ

Tel: 020 8937 5252

Children's Services  
Brent Civic Centre  
Engineers Way  
Wembley  
HA9 0FJ

Licensing Authority  
Fifth Floor  
Brent Civic Centre  
Engineers Way  
Wembley  
HA9 0FJ  
Tel: 020 8937 5359

Area Planning Service  
Brent Civic Centre  
Engineers Way  
Wembley  
HA9 0FJ

Tel: 020 8937 5210

Public Safety Team  
Fifth Floor  
Brent Civic Centre  
Engineers Way  
Wembley  
HA9 0FJ

Tel: 020 8937 5359

DAAT  
Public Health Directorate  
Wembley Centre for Health and  
Care  
116 Chaplin Road  
Wembley  
HA0 4UZ

Home Office Immigration Enforcement  
Alcohol Licensing Team  
Lunar House  
40 Wellesley Road



Date	DATE
5th March 2022	05/03/22
18th March 2022	18/03/22
26th March 2022	26/03/22
30th March 2022	30/03/22
30th March 2022	30/03/22
6th April 2022	06/04/22
8th April 2022	08/04/22
13th April 2022	13/04/22
20th April 2022	20/04/22
27th April 2022	27/04/22
29th April 2022	29/04/22
30th April 2022	30/04/22
7th May 2022	07/05/22
11th May 2022	11/05/22
17th May 2022	17/05/22
18th May 2022	18/05/22

18th May 2022	18/05/22
25th May 2022	25/05/22
31st May 2022	31/05/22
4th June 2022	04/06/22
4th May 2022	04/06/22
7th June 2022	07/06/22
8th June 2022	08/06/22
11th June 2022	11/06/22
15th June 2022	15/06/22
22nd June 2022	22/06/22
2nd July 2022	02/07/22
6th July 2022	06/07/22
13th July 2022	13/07/22
15th July 2022	15/07/22
16th July 2022	16/07/22
19th July 2022	19/07/22
20th July 2022	20/07/22

27 th July 2022	27/07/22
30th July 2022	30/07/22
3rd August 2022	03/08/22
10th August 2022	10/08/22
13th August 2022	13/08/22
17th August 2022	17/08/22
24th Aug 2022	24/08/22
27th Aug 2022	27/08/22
28th August 2022	28/08/22
31st August 2022	31/08/22
3rd September 2022	03/09/22
7th Septmeber	07/09/22
1st October 2022	01/10/22
5th October 2022	05/10/22
12th October 2022	12/10/22
20th October 2022	20/10/22
26th October 2022	26/10/22
27th October 2022	27/10/22
2nd November 2022	02/11/22

**Issue/action**

Loud Music and anti social behaviour

---

Loud music

---

Unbearably loud music

---

Loud Music

---

Loud Music

---

Loud Music

---

Noise from drinkers

---

Loud Music

---

Loud Music and anti social behaviour

---

Loud Music and anti social behaviour

---

Loud music

---

Loud noise from the terraces

---

Loud Music and anti social behaviour

---

Loud base and vibrations

---

MEETING with The Kilburn Arms

---

Loud Music and anti social behaviour

---

---

Texted our feedback which has not been met with a reply

---

One of the loudest evenings

---

Diane Lewis Email

---

Loud Music

---

Loud music

---

Diane Lewis Email

---

Loud music

---

Loud music

---

Loud music

---

Loud music

---

Loud music

---

Loud Music

---

Loud Music and anti social behaviour

---

Loud shouting

---

Loud Music and anti social behaviour

---

Licensing team involved

---

Loud music with open doors to the pub.

---

---

Music started at 7.30pm and went on until after 11pm.

Last recording was at 11.05pm

---

Live music

---

Live Music and Spill out from punters from the pub on to the decking

---

Live music

---

---

Music through a stereo and shouting

---

Loud music

---

---

Loud music and shouting

---

---

Live music with doors open and drunks smoking weed

---

---

MET WITH COSTAS

---

---

Live music

---

Loud Live music

---

---

Live music

---

Live music and weed smells

---

---

Loud music

---

---

Loud Live music - On site visit

---

---

Live music and people singing

---

---

Live music

---

---

Stereo music and loud terrace

---

---

Loud music

---

---



## Comments

Loud music caused server distress this evening and a lot of drunk revellers who did not disperse

Called the pub to ask kindly to turn it down and close doors - but no action was taken by the pub

Loud music and the morning after I had to clean our front door as someone urinated on it

22:49 Music is very loud and feels like it has been turned up

Music is loud and recordings submitted - Music did not stop until after 11pm

Loud music on this occasion woke up my 2 year old. Music didn't stop until after 11pm

Drunk people causing too much noise

Loud music which are shuddering our bedroom wall

Loud music and a crowd of drunks outside of our door who refuse to move on. Music did not stop until after 11pm

Post letter from xxx and it was just as loud if not louder than before

Could not get to sleep as there is a medley of Kareoke and didn't end until after 11pm

Restropective planning for the terrace and it was open until midnight

The drinkers are loud and people didn't disperse until well after 11pm

Music was particularly loud and dispersals from the pub was not smooth. Music went on past 11.30pm. I had to be up at 5am and it was a hard day the next day!

Discussed shutting the terrance at 10.30pm, music off by 11 and customers to leave promptly and quietly. We had said we would be willing to see how it goes with 3x nights a week however we would re-assess the siutation if the noise and nuisance was too much. Our negoitions resulted in them complying with

- All doors to the pub should be closed once the music starts at 8pm

- The back terrace must be closed at 10pm

- The duration should be between 8pm and 11pm with the last song played at 10.55pm

- That they seek ways to sound proof the venue

Music played past 11pm and drunk revellers didn't disperse

Dear xxx

I wanted to come back to you after we met yesterday with regards to the music and how loud it has been. Thank you for your time and suggestions.

I think the doors will have helped but unfortunately the music last night did impact our sleep however we understand that this is your business and we want to be understanding neighbours as I hope you do also. What I would like to propose is for the music to shut off at 11pm and the terraces to be closed at 10.30pm. Also whilst the music is played could you ensure that all the doors leading to the fish and chip shop and terrace are shut? Is there any possibility the band can be moved to the opposite end of the pub I.e furthest away from our house ?

As for the Wednesday night music, this we find impacts us the most as it is mid week and we have to be ready for work in the morning. Would it be possible to shut this music off at 10pm? I understand the music is a big draw for your customers and business...3 nights a week for us to have poor sleep is quite tough especially as our bedroom backs onto your terrace.

Very willing to have another chat to talk through ideas.

Thanks again

Music was loud, doors wide open and it the noise didn't stop until after 11pm

xxx will try to speak with xxx over the phone as he has not responded to her letter dated 20th May

Started earlier at c.7pm and went on until after 11pm

Made a visit to inspect for myself, hardly anyone in the pub at the time of visiting despite the ban in full flow.

xxx Spoke with xxx (Kilburn Arms)

Music went on well past 11pm

Music was played past 11pm and failure to disperse revellers

doors wide open and terrace was loud

Started early around 7.15pm and made it difficult to our children to sleep. Ghe doors to the pub were all open. Failed to disperse drinkers. Lots of noise from people exiting the pub and hanging around.

Loud and doors open

Loud music and doors wide open. Had asked to shut them and they were reluctant to do so. Then they were opened up again.noise continued well past 11pm

I was approached by rude staff who didn't want to shut the doors. They did but for not very long. Pub was still open and creating noise past 11.35pm. It was a loud and raucous night!

Loud shouting since c.7pm and pub didn't seem to get a handle on the noise until they shut after 11pm. Last noise report was at 11.16pm.

Police ref CAD261016072022 - had to call the police 101 as it was loud and caused us server anxiety over noise

xxx spoke withn xxx - letter to be sent to Kilburn arms

Dispersal of punters was ok however music went on past 11pm with the last song played at 11.02pm-11.06

went on past 11pm music and the terrace was loud.
Full on Drms medley which didn't stop until after 11pm
Music shut off after 11pm and disoiersal of punters didn't end until midnight
Doors to the pub are wide open and I had to go round to ask them to close them. They were opened again when I had left. Music wasn't fully shut off until 1120pm
Loud
The beer garden/terrace was supposed to have closed at 1030pm but noise can still be heard and its getting rather rowdy.
Doors are wide open and we are struggling to sleep after a very hard day at work. No peace and quiet. Music went on past 11pm and punters have been knocking on our door drunk!
Doors wide open and once the music eventually shut off after 11pm, there was a stereo system playing on the terrace which prolonged their party and our living hell to continue!
reinforced our agreed terms as stated on the 17th May. all doors to the pub should be closed once the music starts at 8pm
the back terrace must be closed at 10pm
the duration should be between 8pm and 11pm with the last song played at 10.55pm
that they seek ways to sound proof the venue
last recording submits past 11pm and then a medly of sporadic drums at 1130pm
Drum and loud noise coming from the desk at the back. Bottle smashed and a strong smell of weed we can smell coming into our bedroom
went on past 11pm and the doors are wide open. The music went on until 1115pm
this music tonight woke up our children and it went on until 1143pm!!!!the loudest and longest thus far!
Not many in the pub this evening but they have a live band and its loud with doors open! At 2210 it woke up my eldest daughter and she said she felt scared as there was loud shouting and aggressive behaviour which could be heard.
I visited the pub to speak with the on duty manager at 2134, after returning the music was even louder and we could see the doors were then opened up. There was then a lot of arguing on the front decking at 2347
1230am people singing and shouting on a Wednesday night! Police called as the mood was turning aggressive and a strong smell of weed coming into our bedroom.
1115 pm when the music was shut off then music was pumped out via a stereo on to the front terrace. The abuse we have been enduring is getting worse and songs were belted out at 1230am on a Wednesday night. The police were called and a report submitted to the Met police over the antisocial behaviour and smell of weed again!
1222am people shouting and stereo on the terrace - continuous noise at an unacceptable hour of the night!
Loud music with doors open.

This page is intentionally left blank

**From:** Lewis, Diane <Diane.Lewis@brent.gov.uk>  
**Sent:** 04 December 2022 01:16  
**To:** Business Licence <business.licence@brent.gov.uk>  
**Subject:** RE: CONSULT: Review - The Kilburn Arms, 97-101 Willesden Lane, NW6 7SD - 26627

Dear Business Licence Team,

I would like to confirm that I have considered the above proposal with regard to the prevention of public nuisance. On behalf of the Environmental Health I would like to:

Make representations in support of the Review on the following grounds:

The noise caused by loud amplified music (and in particular live music) and vocals is likely to be detrimental to the residential amenity. The nearest noise sensitive property is directly adjacent to the premises, therefore increasing the likelihood of residents suffering from loss of amenity should inadequate measures be taken to reduce the level of noise.

I have met with both the applicant and the Designated Premises Supervisor of the Kilburn Arms with a view of controlling noise levels that are suitable for a mixed commercial/residential area. I have taken into account the view of both parties. Whilst there is a need to ensure that businesses are able to thrive, we must also take into account the potential for loud amplified music to create a statutory noise nuisance to local residents. On speaking with the DPS and manager of the Kilburn Arms, there is a clear desire to have live music. However, I have recommended the consideration of sound insulation to the wall nearest to the applicants property as noise from drums and other instruments are incapable of being controlled by an amplifier.

Our investigations have included assessment of time and date-stamped recordings made by the applicant using the Brent Noise App conveying loud amplified music and noise from the terraced area after 11pm. The applicant has also reported excessive levels of noise from amplified and live music regularly on weekdays (Wednesdays). Investigations have included visits to the area and officers have noted that on occasion, the front doors have been left open during the playing of live music, increasing the level of breakout music from the premises.

The applicant recently submitted a Noise App recording regarding the playing of loud amplified music at 00:28 on 27/10/22. I have called and emailed the Kilburn Arms and emailed in order to discuss this incident but to date, I have not received a response

I would therefore recommend the following conditions:

- No noise or vibration shall be detectable at any neighbouring noise sensitive premises after 23:00. The level of music at all times shall be arranged so as not to cause a nuisance to local residents.
- All doors and windows shall remain closed during any licensable activity and where a door is used for patrons to enter or leave the premises the door shall be lobbied and fitted with a self-closing device.
- The rear outside drinking areas shall cease at 22:00 hours
- Notices asking customers to leave quietly shall be conspicuously displayed at all exits
- Customers will not be permitted the talk loudly in the street or to loiter outside the premises.

- Signs shall be placed in the garden on the frontage instructing patrons to recognise the residential nature of the area and conduct their behaviour accordingly -The management shall reserve the right to ask patrons to move inside the premises or leave if it felt that they could be disturbing neighbours

Kind regards,

Diane Lewis  
Nuisance Control Officer  
Community Protection  
Resident Services  
Brent Council

---

The Kilburn Arms  
97-101 Willesden Lane  
NW6 7SD

05/12/2022

Our Ref: 26627

Dear Business Licence,

**Licensing Representation to the application for a review of premises licence under Sec 51 of the Licensing Act 2003 for premises at KILBURN ARMS, 97-101 WILLESDEN LANE, LONDON, NW6 7SD.**

The application for the review has been made by [REDACTED] in the capacity of an individual who is not a responsible authority.

**I am an officer of the Licensing Authority, in whose area the premises are situated, who is authorised for the purposes of exercising its statutory function as a 'Responsible Authority' under the Licensing Act 2003.**

The Licensing Authority representations are primarily concerned with the four licensing objectives;

- the prevention of crime and disorder;
- public safety;
- the prevention of public nuisance; and
- the protection of children from harm.

1. I have considered the application and I wish to make a representation. In reaching my decision, consideration has been given to the relevant provisions of the Licensing Act 2003 - in particular the guidance issued under Section 182 of the Act and the London Borough of Brent Statement of Licensing Policy 2020 – 2025.
2. I have been aware of ongoing noise related complaints from [REDACTED] against the Kilburn Arms. On 18/07/2022 I was assigned service request 7217 following a complaint from [REDACTED].  
Appendix 1 – Email from [REDACTED] dated 16/07/2022  
Appendix 2 – Cars double parked  
Appendix 3 – Pub door open  
Appendix 4 – Video of customers drinking in the street

3. On 18/07/2022 I had an email from Brent Council Nuisance Control Officer, Diane Lewis, stating that she is dealing with [REDACTED] noise complaint and that she has been dealing with the Designated Premises Supervisor at the pub.
4. On 19/07/2022 I sent an email to the Designated Premises Supervisor - Mr. Constantin Tofan. In this email I informed Mr. Tofan that I was aware of the noise complaint and made enquiries re the pubs compliance with conditions on the premises licence. I never received any reply to this email.

Appendix 5 – Email to DPS dated 19/07/2022

5. Appendix 5 also contains an email trail between Evie and myself. In this trail I also stated that I was going to advise the complainants that I have insufficient evidence to apply for a review of the premises licence, but this is an option that is open to them to consider if they feel your premises has undermined any of the licensing objectives.

The Home Office guidance issued under Section 182 of the Licensing at para 11.5 states

“Any responsible authority under the 2003 Act may apply for a review of a premises licence or club premises certificate. Therefore, the relevant licensing authority may apply for a review if it is concerned about licensed activities at premises and wants to intervene early without waiting for representations from other persons. However, it is not expected that licensing authorities should normally act as responsible authorities in applying for reviews on behalf of other persons, such as local residents or community groups. These individuals or groups are entitled to apply for a review for a licence or certificate in their own right if they have grounds to do so. It is also reasonable for licensing authorities to expect other responsible authorities to intervene where the basis for the intervention falls within the remit of that other authority. For example, the police should take appropriate steps where the basis for the review is concern about crime and disorder or the sexual exploitation of children. Likewise, where there are concerns about noise nuisance, it is reasonable to expect the local authority exercising environmental health functions for the area in which the premises are situated to make the application for review”

6. [REDACTED] has exercised his right to apply for a review which I feel has been justified. He resides with his family close to the premises and the effects of loud music on a Wednesday night does appear to have a detrimental effect on this family's quality of life. [REDACTED] appears to have tried to work with the pub but to no avail.
7. On Thursday 10/11/2022 I attended the Kilburn Arms to place the Blue Notice on a nearby lamppost. This is a statutory requirement under Regulation 25 of The Licensing Act ( Premises licences and club premises certificates) Regulations 2005. I then entered the pub to notify them about this. I then met with Evie who was working.
8. During this meeting I explained that a review application had been received and I explained the process. I explained that the review was centred around noise nuisance caused mainly by the live music on a Wednesday. Evie explained that the premises licence allows the playing of live music until midnight on Sunday to Monday and 01.00am on Friday and Saturday.



9. Evie further stated that they had voluntarily to reduce this to 1.00pm on Wednesday nights because of the complaints by [REDACTED] and she stated that the bans on occasions had gone on a little past 11.00pm. She also stated that reducing the time from midnight to 11.00pm had cost them up to £45000 per week as most of the customers attended late into the night.
10. Evie also stated that the pub used to have a good relationship with [REDACTED] and that they used to take parcel deliveries for him. But this relationship has turned sour in recent times as she stated that [REDACTED] would sometimes be abusive when attending the pub to complain about loud music.
11. I have read [REDACTED] review application and I feel the sanctions he seeks are proportionate to help the premises promote the licensing objectives for residents living nearby.

I feel that the pub has not been pro-active enough in dealing with the noise complaints raised by [REDACTED] I also feel that some action needs to be taken or this problem will continue. This will have a detriment effect on local residents and an unnecessary demand on council resources.

I support [REDACTED] application.

Yours sincerely

*John McGann*

John McGann  
Licensing Officer  
Regulatory Services

This page is intentionally left blank

**From:** [REDACTED]  
**Sent:** 16 July 2022 19:21  
**To:** Business Licence; SNTQK-Kilburn@met.police.uk; [REDACTED] Lewis, Diane  
**Subject:** Kilburn Arms pub - antisocial behaviour, noise and license  
**Attachments:**

Dear sir/madam,

I hope you are well?

I wanted to bring to your attention the issues we have been having with The Kilburn Arms , 97-101 Willesden lane, NW67SD. They are unfortunately still making our home life unbearable on Wednesday, Friday and Saturday nights and we have been in contact with the noise team at Brent Council (Diane Lewis), Who has been very helpful.

On Wednesday night (13th July) I had to visit the pub to kindly ask them to close their doors as the music was particularly loud. The music started at c.7.15pm and went on until 11pm. Soon after I visited the pub (c.8pm) they then opened the doors up again but thought it was futile in going round again as the manager was quite rude and abrupt with me the first time.

When the music ended, the drinkers stayed for a good hour outside of our door and on their front terrace (which I believe has retrospective planning) making alot of noise and revving their car engines. This then woke up my 7month old baby at 12.15 am.

I am afraid the situation is getting worse as every week passes. Wednesday nights are particularly bad and we are left feeling shattered every Thursday morning, often struggling to function properly at work.

Again last night (15th July), they failed to disperse their 'punters' until 12.30am and I logged a ticket with the Met police (CAD 2610 16/07/2022) so they could review the issue. We are living in fear as tonight is set to be loud again and we are suffering from lack of sleep now and our anxiety levels are running high.

I wish to understand if it is possible to formally review their music license and operating hours, as from what I have observed, other pubs in the local area stop live music at 10.30-10.45pm and everyone has to disperse by 11.15pm.

Why is the Kilburn Arms so different and lack any form of respect for their neighbours?

Please find attached photo evidence of the doors open, cars registrations, and drinkers on the street (23.36, time of filming).

I look forward to hearing from you on what the next steps might be?

Kind regards,

[REDACTED]  
**CAUTION:** This email originated from outside of the organisation. Do not click links or open attachments unless you recognise the sender and know the content is safe

This page is intentionally left blank



This page is intentionally left blank

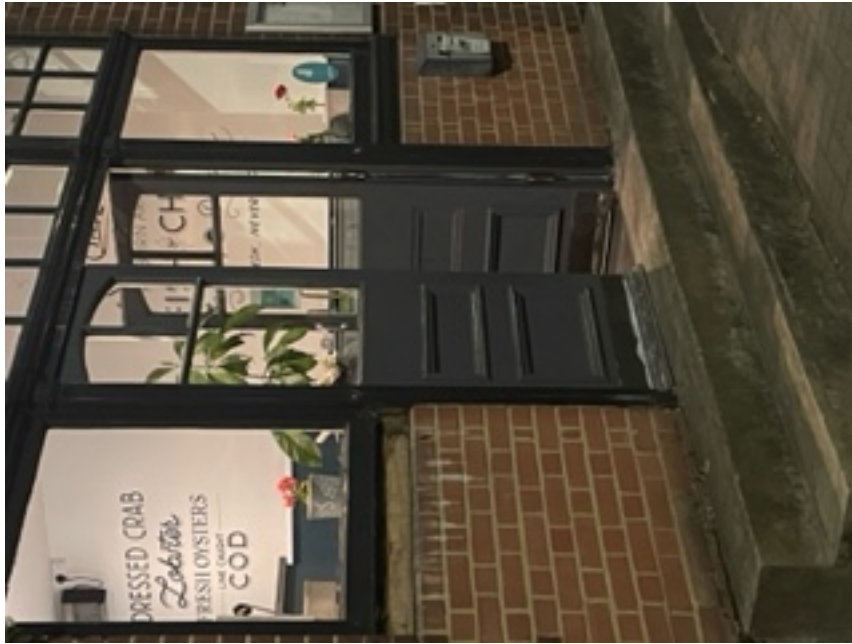

This page is intentionally left blank



**From:** McGann, John  
**Sent:** 11 August 2022 11:45  
**To:** 'Kilburn Arms'  
**Subject:** RE: Kilburn Arms Complaint  
**Attachments:** Video.mov

**Categories:** Egress Switch: Unprotected

Dear Evie,

I am still receiving complaints about noise nuisance from the Kilburn Arms. I appreciate the hot weather is playing a factor in this with doors being kept open and customers wanting to be outside rather than inside.

But, just to remind you that the pub has an On-Licence which means that drinks are not allowed to be taken off the premises. The attached video suggests that this has been happening in breach of your licence. Please make sure this is managed better.

Also, if the doors could be kept closed when any live music is taking place then that will help to minimise risk.

I am going to advise the complainants that I have insufficient evidence to apply for a review of the premises licence but this is an option that is open to them to consider if they feel your premises has undermined any of the licensing objectives.

Kind Regards

John McGann  
Licensing Officer  
Regulatory Services  
Brent Council



[www.brent.gov.uk](http://www.brent.gov.uk)  
@Brent\_Council

---

**From:** Kilburn Arms [REDACTED]  
**Sent:** 22 July 2022 15:49  
**To:** McGann, John <[John.McGann@brent.gov.uk](mailto:John.McGann@brent.gov.uk)>  
**Subject:** Re: Kilburn Arms Complaint

Ok just as i thought thank you

Yes we are not open past midnight as mentioned before live music stops 11 pm and the sale of alcohol stops at 12 am

Also 90% of our customers on those 2 nights are regulars and local residents that live within the area, they all are very respectful people and we generally don't have a problem with people leaving the bar usually takes us around 30min max

A lot of them leave just after 11pm when the bands stop and the rest usually doesn't have to be pushed out they leave peacefully if you look at our track record since i have taken over this site i haven't had any trouble at all and hoping to keep it that way

Pls let me know if you need anything else from me

Thank you

Regards

Evie

The Kilburn Arms Team

[REDACTED]

[thekilburnarms.co.uk](http://thekilburnarms.co.uk)

On Fri, 22 Jul 2022 at 15:31, McGann, John <[John.McGann@brent.gov.uk](mailto:John.McGann@brent.gov.uk)> wrote:

Evie,

Thank you for confirming. As the condition states you only need at SIA if you are open for the sale of alcohol past midnight.

But, the timings for the use of SIA may need to be looked at to help with dispersing customers at closing time on nights when live music is being provided.

Kind Regards

John McGann

Licensing Officer

Regulatory Services

Brent Council

[REDACTED]

[REDACTED]

[www.brent.gov.uk](http://www.brent.gov.uk)

@Brent\_Council

---

**From:** Kilburn Arms <[kilburnarms@gmail.com](mailto:kilburnarms@gmail.com)>  
**Sent:** 22 July 2022 15:13  
**To:** McGann, John <[John.McGann@brent.gov.uk](mailto:John.McGann@brent.gov.uk)>  
**Subject:** Re: Kilburn Arms Complaint

John

We have not been using security as we have been stopping live music by 11 pm and we have been closing the bar by midnight

From my understanding I was sure that i only need door supervisors if we operate past midnight which we don't ? Pls advise

Kind regards,

Evie

The Kilburn Arms Team

[REDACTED]  
[thekilburnarms.co.uk](http://thekilburnarms.co.uk)

On Fri, 22 Jul 2022 at 14:32, McGann, John <[John.McGann@brent.gov.uk](mailto:John.McGann@brent.gov.uk)> wrote:

Hi Evie,

Thank you for your email.

I don't see any reference in relation to my query on your use of SIA Door Staff which is conditioned on your licence;

9. Door supervisors of a sufficient number and gender mix, shall be employed from 20:00 hours on any day when the premises are open for the sale of alcohol past midnight.

Please confirm what the situation is with this please and confirm what company you use?

Kind Regards

John McGann

Licensing Officer

Regulatory Services

Brent Council

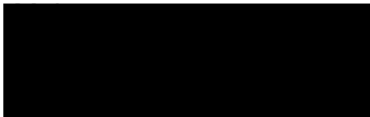

[www.brent.gov.uk](http://www.brent.gov.uk)

@Brent\_Council

---

**From:** Kilburn Arms [REDACTED]  
**Sent:** 22 July 2022 14:28  
**To:** McGann, John <[John.McGann@brent.gov.uk](mailto:John.McGann@brent.gov.uk)>  
**Subject:** Fwd: Kilburn Arms Complaint

Hi John hope you well

My apologies I have replied to the email I have received from Diane on Tuesday regards to noise assessment this Saturday which we have agreed to (I'm forwarding this below)

Only now i have realized that above her email there was one from yourself once again apologies for not seeing it in first place.

To respond to your email which misusers that we take to minimize noise and risk are following

~ we keep all doors closed at all times once live music starts that includes both front doors, kitchen/take away shop door, garden door

~ we close the door between kitchen and the bar once music starts (neighbor that complains his wall and our kitchen wall are right next to each other)

~we have installed a curtain between kitchen and bar that goes over the door to minimize the noise

~ we close our garden at 10:30 pm and ask everyone to go inside

~ our front deck gets closed at 11pm

~ we stop live music at 11 pm sharp

~ we (the the owner and myself) have given our neighbor our personal number so he could always get in touch with us if there's any problems but atm we there every Wednesday and Saturday until the issue gets resolved

~ always more then 1 manger on duty

~ regular floor and toilet checks to ensure safety of our customers,

~designated floor attendants

~ children are not allowed on premises on nights when we have events

~ we employed professional sound engineer to keep sound levels low

~ we do not serve any take away drinks

I am confident that we comply with all conditions of our license and we do everything in our power to run and promote safe and friendly Local Pub but we are always happy to discuss any further safety misusers that we could apply in our pub.

Please let me know if there is anything else that i can help with or even if you wish to meet im available any day of the week.

Thank you

Kind regards,

Evie

The Kilburn Arms Team

██████████

[thekilburnarms.co.uk](http://thekilburnarms.co.uk)

----- Forwarded message -----

From: **Kilburn Arms** <██████████>  
Date: Wed, 20 Jul 2022 at 18:01  
Subject: Re: Kilburn Arms Complaint  
To: Lewis, Diane <[Diane.Lewis@brent.gov.uk](mailto:Diane.Lewis@brent.gov.uk)>

Hi Diane

Hope youre well, sorry for the late reply I was off yesterday.

I am more than happy for an assessment to be carried out, I only wish we had done this sooner. Especially after the weekend when I experienced aggressive behavior from ██████████ (please correct my spelling if incorrect regarding his name). We are doing everything we can to accommodate them, unfortunately it feels as though this is never enough if only we could meet in the middle on these compromises. I want nothing but a good relationship with our neighbours , and I am finding this situation deeply upsetting. I give full consent to an assessment and only hope this will resolve the current issues.

Kind regards,

Evie

The Kilburn Arms Team

  
[thekilburnarms.co.uk](http://thekilburnarms.co.uk)

On Wed, 20 Jul 2022 at 16:08, Lewis, Diane <[Diane.Lewis@brent.gov.uk](mailto:Diane.Lewis@brent.gov.uk)> wrote:

Dear Costas and Izzie,

Further to Mr McGann's email below, I wanted to add another couple of points.

Last week we received further complaints alleging that the music was excessive including a complaint from residents at a different property. The complainants sent Noise App reports for noise on 13<sup>th</sup>, 15<sup>th</sup> and 16<sup>th</sup> July. Whilst the Noise App is useful, it is still my aim, as previously discussed to carry out an assessment during a Saturday night. The assessment will give us a better understanding of how the noise is perceived within the complainant's home. I will let you know once this has been arranged with one of the complainants where we will hopefully be able to agree acceptable noise levels in relation to live amplified music.

Live unamplified music, however still presents a challenge in particular drums and other instruments that are unable to be controlled electronically. Once we have carried out the assessment, I will be able to offer you further advice.

Regards,

Diane Lewis

Nuisance Control Officer

Community Protection

Regeneration and Environment

Brent Council

020 8937 1096

[www.brent.gov.uk](http://www.brent.gov.uk)

---

**From:** McGann, John <[John.McGann@brent.gov.uk](mailto:John.McGann@brent.gov.uk)>  
**Sent:** 19 July 2022 13:17  
**To:** [Kilburnarms](#) [REDACTED]  
**Cc:** Lewis, Diane <[Diane.Lewis@brent.gov.uk](mailto:Diane.Lewis@brent.gov.uk)>  
**Subject:** Kilburn Arms Complaint

Dear Mr. Constantin Tofan,

I am one of the LB Brent Licensing Officers that covers your pub. I am aware of a complaint that is being investigated by one of my colleagues in Noise Nuisance who has been in contact with you.

As an officer of the Licensing Authority my role is to offer advice and assistance to help promote the 4 Licensing Objectives, which are;

- the prevention of crime and disorder;
- public safety;
- the prevention of public nuisance; and.
- the protection of children from harm.



I believe you have met with a local resident and agreed some measures to help minimise risk – I would be grateful for a summary of these measure and if you are still complying with them?

Also, I would like to know if the following conditions on your premises licence are being complied with as these were part of the operating schedule and are on there to help promote the prevention of public nuisance.

#### **Annex 2 – Conditions consistent with the operating schedule**

5. Regular surveys (checks) shall be carried out when the premises are used for entertainment t ensure the level of music is arranged so as not to cause a nuisance to local residents

9. Door supervisors of a sufficient number and gender mix, shall be employed from 20:00 hours on any day when the premises are open for the sale of alcohol past midnight.

11. Outside drinking shall only be allowed at the tables provided and no customer shall be allowed to take glasses or bottles away.

12. The use of the outside tables shall cease at 23:00 hours each day.

The promotion of the licensing objectives and achieving common aims relies on a partnership between licence holders, authorised persons, interested parties, responsible authorities and the Council. The Council's Licensing Authority is keen to work in partnership with licensees to develop a prosperous and well managed economy whilst promoting the licensing objectives. But, we must carry out our functions under the Licensing Act 2003 with a view to promoting the four licensing objectives. I am keen to help resolve this without the need for a formal review of your licence.

I would be grateful if you would treat this email as a matter of urgency and I look forward to your reply in relation to the questions raised above.

Kind Regards

John McGann

Licensing Officer

Regulatory Services

Brent Council

Mob: 07500578229

Tel: 0208 937 2054

[www.brent.gov.uk](http://www.brent.gov.uk)

@Brent\_Council

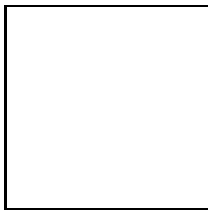

---

The use of Brent Council's e-mail system may be monitored and communications read in order to secure effective operation of the system and other lawful purposes.

**CAUTION: This email originated from outside of the organisation. Do not click links or open attachments unless you recognise the sender and know the content is safe**

**CAUTION: This email originated from outside of the organisation. Do not click links or open attachments unless you recognise the sender and know the content is safe**

**CAUTION: This email originated from outside of the organisation. Do not click links or open attachments unless you recognise the sender and know the content is safe**

This page is intentionally left blank

**Sent:** 01 December 2022 14:26

**To:** Business Licence <business.licence@brent.gov.uk>

**Subject:** The Kilburn Arms 97-101 Willesden Lane

I saw your notice on a lamppost about the Kilburn arms license.

I had been using the noise app to try and report the constant loud noise when they have music events on & wasn't sure if anything was happening so good to see it is now being reviewed!

Last Saturday the live music usually finished about 11, though started up again and went on to 12.30 so I wondered if they had managed to extend their music licence.

They seem to have music on Wednesday, Friday, and Saturday and sometimes Sunday.

Therefore, we only have a few nights respite from the constant background noise of loud music. I have a friend who lives a few streets away and he can hear the vibrations in his flat.

Our flat is [REDACTED] [REDACTED] from the pub and we can hear bass vibrations throughout the night.

In the summer it's much worse as they leave the doors open so the music is much louder plus you have people outside shouting to be heard over the loud music.

When they have live music, I notice a lot more anti-social behaviour opposite our flat which often includes drugs use and urinating on the street.

It would be good if the pub had some way in limiting any live music sounds or could have a limit on the volume levels.

I also thought the front outdoor seating area didn't have a planning application for it and was left over from the previous landlord. Now they have a back beer garden perhaps this could be removed to cut down on anti-social behaviour as this is often used after the pub closes with drunken people arguing throughout the night. Perhaps this could also be investigated as well.

This page is intentionally left blank

**Sent:** 07 December 2022 21:41

**To:** Business Licence <business.licence@brent.gov.uk>

**Subject:** The Kilburn Arms - Public License Review

to business.licence

To whom it may concern,

A pub should be at the heart of every community in being both a place to gather and socialise, as well as acting as bastion of the communities values.

On the surface, the Kilburn Arms appears to do just this but in fact underneath the surface, this pub does not work with its local community and simply does not care about complaints that come its way from local residents. When we lived in Farringdon in Central London, we were surrounded by pubs; at least 6-7. And whenever there was an issue - as there was fairly frequently - they all worked hard with the community to do right and be the best neighbour possible; even when it was a problem that was not theirs in the making. This is not the case with the Kilburn Arms, who frankly don't respond to complaints, be it about building without permission, noise (the live music on wednesday night being a particular issue) or anti-social customers and think they don't need to be responsible on any front. And this is why change is needed. Pubs - or any business - should not be above the law or the community. I'm not opposed to their being a pub but this one needs some serious restrictions if it continues as is.

I would prefer my representation is kept anonymous to prevent any repercussions. A small sign of the problem here...

Thanks for your time.

This page is intentionally left blank





**Brent**

Planning, Transportation & Licensing  
Brent Civic Centre  
Engineers Way  
Wembley  
HA9 0FJ

TEL: 020 8937 5359  
EMAIL: [business.licence@brent.gov.uk](mailto:business.licence@brent.gov.uk)  
WEB: [www.brent.gov.uk](http://www.brent.gov.uk)

**London Borough of Brent**

**Premises Licence**

**Part A**

*This Premises Licence was granted by Brent Council, Licensing Authority for the area of the Borough of Brent under the Licensing Act 2003*

**Original grant date: 19 September 2005**  
**Current issue date: 13 December 2017**

---

Authorised signatory

**Premises licence number:**  
**165236**

**Part 1 – premises details**

Postal address of premises, or if none, ordinance survey map reference or description

**The Prince of Wales**  
**97 - 101 Willesden Lane, Kilburn, London, Brent, NW6 7SD**

Where the licence is time limited the dates

Licensable activities authorised by the licence

**Section Indoor sporting events:()**  
**Section Anything of a similar description to that falling within (E), (F) or (G): (Indoors)**  
**Section Performance of dance:(Indoors)**  
**Section Recorded Music:(Indoors)**  
**Section Live Music:(Indoors)**  
**Section I: Provision of Late Night Refreshments:(Indoor)**  
**Section J: Sale or Supply of Alcohol:(On the premises)**

The times the licence authorises the carrying out of licensable activities

<b>Section Indoor sporting events:()</b>		
<b>Day</b>	<b>Start Time</b>	<b>End Time</b>

Monday	20:00	00:00
Tuesday	20:00	00:00
Wednesday	20:00	00:00
Thursday	20:00	00:00
Friday	20:00	00:00
Saturday	20:00	00:00
Sunday	20:00	00:00

We would like to have some racing evenings

We would like have some racing evenings. We would also like to have a ladies & mens darts team plus pool teams.

**Section Anything of a similar description to that falling within (E), (F) or (G):  
(Indoors)**

<b>Day</b>	<b>Start Time</b>	<b>End Time</b>
Monday	11:00	00:00
Tuesday	11:00	00:00
Wednesday	11:00	00:00
Thursday	11:00	00:00
Friday	11:00	01:00
Saturday	11:00	01:00
Sunday	11:00	00:00

**Section Performance of dance:  
(Indoors)**

<b>Day</b>	<b>Start Time</b>	<b>End Time</b>
Monday	20:00	00:00
Tuesday	20:00	00:00
Wednesday	20:00	00:00
Thursday	20:00	00:00
Friday	20:00	01:00
Saturday	20:00	01:00
Sunday	20:00	00:00

Christmas Eve, Boxing day, New year Eve, St Patricks, Valentines Day, St Georges Day until 01:00hrs Easter Saturday and Sunday.

**Section Recorded Music:(Indoors)**

<b>Day</b>	<b>Start Time</b>	<b>End Time</b>
Monday	20:00	00:00
Tuesday	20:00	00:00
Wednesday	20:00	00:00
Thursday	20:00	00:00
Friday	20:00	01:00
Saturday	20:00	01:00
Sunday	20:00	00:00

Christmas, New Year, St Patrick"s Day, Georges Day, Valentines day until 01.00hrs, Boxing night.

**Section Live Music:(Indoors)**

<b>Day</b>	<b>Start Time</b>	<b>End Time</b>
Monday	20:00	00:00
Tuesday	20:00	00:00
Wednesday	20:00	00:00
Thursday	20:00	00:00
Friday	20:00	01:00
Saturday	20:00	01:00

Sunday	20:00	00:00
--------	-------	-------

Christmas Eve, St George Day & St Patricks Day, New Years Eve - Until 01.00hrs, Valentines Day, Boxing night.

**Section I: Provision of Late Night Refreshments:  
(Indoor)**

Day	Start Time	End Time
Monday	23:00	01:00
Tuesday	23:00	01:00
Wednesday	23:00	01:00
Thursday	23:00	01:00
Friday	23:00	02:00
Saturday	23:00	02:00
Sunday	23:00	02:00

**Section J: Sale or Supply of Alcohol:(For consumption on the premises)**

Day	Start Time	End Time
Monday	10:00	02:00
Tuesday	10:00	02:00
Wednesday	10:00	02:00
Thursday	10:00	02:00
Friday	10:00	02:00
Saturday	10:00	02:00
Sunday	10:00	02:00

Christmas Eve, New years eve, St Patricks day St Georges day, Valentines night, Boxing night

Christmas Eve, Boxing day, New years eve, Easter Saturday and Sunday, St Valentines day, St Georges Day, St Patricks day.

The opening hours of the premises

Day	Start Time	End Time
Monday	10:00	02:30
Tuesday	10:00	02:30
Wednesday	10:00	02:30
Thursday	10:00	02:30
Friday	10:00	02:30
Saturday	10:00	02:30
Sunday	10:00	02:30

Christmas Eve, New year Eve, St Patricks Day, St Georges Day, Boxing night.

Where the licence authorises supplies of alcohol whether these are on and/or off supplies

**For consumption on the premises**

**Part 2**

Name, (registered) address, telephone number and email (where relevant) of holder of the premises licence

**Beronmoor Limited**  
**Beronmoor Limited**

Registered number of holder, for example company number, charity number (where applicable)

Name, address and telephone number of designated premises supervisor where the premises licence authorises the supply of alcohol

**Mr Constantin Tofan**

Personal licence number and issuing authority of personal licence held by designated premises supervisor where the premises licence authorises the supply of alcohol

**Licence Number:**

**Issuing authority:**

## **Annex 1 – Mandatory conditions**

### **No Irresponsible Drinks Promotions**

(1) The responsible person must ensure that staff on relevant premises do not carry out, arrange or participate in any irresponsible promotions in relation to the premises.

(2) In this paragraph, an irresponsible promotion means any one or more of the following activities, or substantially similar activities, carried on for the purpose of encouraging the sale or supply of alcohol for consumption on the premises—

1. (a) games or other activities which require or encourage,

or are designed to require or encourage, individuals to— (i) drink a quantity of alcohol within a time limit (other than to drink alcohol sold or supplied on the premises before the cessation of the period in which the responsible person is authorised to sell or supply alcohol), or (ii) drink as much alcohol as possible (whether within a time limit or otherwise);

(b) provision of unlimited or unspecified quantities of alcohol free or for a fixed or discounted fee to the public or to a group defined by a particular characteristic in a manner which carries a significant risk of undermining a licensing objective;

(c) provision of free or discounted alcohol or any other thing as a prize to encourage or reward the purchase and consumption of alcohol over a period of 24 hours or less in a manner which carries a significant risk of undermining a licensing objective;

(d) selling or supplying alcohol in association with promotional posters or flyers on, or in the vicinity of, the premises which can reasonably be considered to condone, encourage or glamorise anti-social behaviour or to refer to the effects of drunkenness in any favourable manner;

(e) dispensing alcohol directly by one person into the mouth of another (other than where that other person is unable to drink without assistance by reason of disability).

### **Free Water**

The responsible person must ensure that free potable water is provided on request to customers where it is reasonably available.

### **Age Verification Policy**

(1) The premises licence holder or club premises certificate holder must ensure that an age verification policy is adopted in respect of the premises in relation to the sale or supply of alcohol.

(2) The designated premises supervisor in relation to the premises licence must ensure that the supply of alcohol at the premises is carried on in accordance with the age verification policy.

(3) The policy must require individuals who appear to the responsible person to be under 18 years of age (or such older age as may be specified in the policy) to produce on request, before being served alcohol, identification bearing their photograph, date of birth and either—

(a) a holographic mark, or

(b) an ultraviolet feature.

### **Small Measures to be Available**

The responsible person must ensure that—

(a) where any of the following alcoholic drinks is sold or supplied for consumption on the premises (other than alcoholic drinks sold or supplied having been made up in advance ready for sale or supply in a securely closed container) it is available to customers in the following measures—

(i) beer or cider: ½ pint;

(ii) gin, rum, vodka or whisky: 25 ml or 35 ml; and

(iii) still wine in a glass: 125 ml;

(b) these measures are displayed in a menu, price list or other printed material which is available to customers on the premises; and

(c) where a customer does not in relation to a sale of alcohol specify the quantity of alcohol to be sold, the customer is made aware that these measures are available

### **Minimum Price of Alcohol**

**1.** A relevant person shall ensure that no alcohol is sold or supplied for consumption on or off the premises for a price which is less than the permitted price.

**2.** For the purposes of the condition set out in paragraph 1—

(a)—duty|| is to be construed in accordance with the Alcoholic Liquor Duties Act 1979;

(b)—permitted price|| is the price found by applying the formula—

$$P = D + (D \times V)$$

where—

(i) P is the permitted price,

(ii) D is the amount of duty chargeable in relation to the alcohol as if the duty were charged on the date of the sale or supply of the alcohol, and

(iii) V is the rate of value added tax chargeable in relation to the alcohol as if the value added tax were charged on the date of the sale or supply of the alcohol;

(c)—relevant person|| means, in relation to premises in respect of which there is in force a premises licence—

(i) the holder of the premises licence,

(ii) the designated premises supervisor (if any) in respect of such a licence, or

(iii) the personal licence holder who makes or authorises a supply of alcohol under such a licence;

(d) —relevant person|| means, in relation to premises in respect of which there is in force a club premises certificate, any member or officer of the club present on the premises in a capacity which enables the member or officer to prevent the supply in question; and

(e)—valued added tax|| means value added tax charged in accordance with the Value Added Tax Act 1994.

3. Where the permitted price given by Paragraph (b) of paragraph 2 would (apart from this paragraph) not be a whole number of pennies, the price given by that sub-paragraph shall be taken to be the price actually given by that sub-paragraph rounded up to the nearest penny.

4.(1) Sub-paragraph (2) applies where the permitted price given by Paragraph (b) of paragraph 2 on a day (—the first day||) would be different from the permitted price on the next day (—the second day||) as a result of a change to the rate of duty or value added tax.

(2) The permitted price which would apply on the first day applies to sales or supplies of alcohol which take place before the expiry of the period of 14 days beginning on the second day.

#### **Requirement for a DPS**

(1) No supply of alcohol may be made under the premises licence—

(a) at a time when there is no designated premises supervisor in respect of the premises licence, or

(b) at a time when the designated premises supervisor does not hold a personal licence or their personal licence is suspended.

(2) Every supply of alcohol under the premises licence must be made or authorised by a person who holds a personal licence.

#### **Door Supervisors and Security Staff to be Licensed by the SIA (when required)**

Where the licence includes a condition that at specified times one or more individuals must be at the premises to carry out a security activity, each individual must be licensed by the Security Industry Authority, with the following exceptions:

a) premises where the premises licence authorises plays or films

b) any occasion mentioned in paragraph 8(3)(b) or (c) of Schedule 2 to the Private Security Industry Act 2001 (premises being used exclusively by a club with a club premises certificate, under a temporary event notice authorising plays or films or under a gaming licence), or

c) any occasion within paragraph 8(3)(d) of Schedule 2 to the Private Security Industry Act 2001

#### **Film Classification When required**

(i) The admission of children to the exhibition of any film must be restricted in accordance with the recommendation of the designated film classification body unless section (ii) applies.

(ii) Where the licensing authority notifies the holder of the licence that this subsection applies the admission of children must be restricted in accordance with any recommendation made by the licensing authority.

In this section—

"children" means persons aged under 18; and

"film classification body" means the person or persons designated as the authority

under section 4 of the Video Recordings Act 1984 (c. 39) (authority to determine suitability of video works for classification).

**Annex 2 – Conditions consistent with the operating schedule**

1. The Portman Group proof of age scheme or similar such scheme shall be adopted.
2. Toilets shall be checked regularly for the use of drugs and other illegal activities.
3. Adequate and appropriate first aid equipment shall be available on the premises.
4. Suitable and sufficient fire fighting equipment shall be provided and maintained in good order.
5. Regular surveys (checks) shall be carried out when the premises are used for entertainment to ensure the level of music is arranged so as not to cause a nuisance to local residents
6. Notices advertising the number of a local licensed taxi service shall be displayed in a prominent position.
7. CCTV shall be installed and maintained in a working condition. (This condition shall take effect from 1st January 2007).
8. All CCTV recordings shall be kept for 31 days and shall be made available to police and licensing officers if requested.
9. Door supervisors of a sufficient number and gender mix, shall be employed from 20:00 hours on any day when the premises are open for the sale of alcohol past midnight.
10. A copy of the premises licence summary including the hours which licensable activities are permitted shall be visible from the outside of each entrance to the premises.
11. Outside drinking shall only be allowed at the tables provided and no customer shall be allowed to take glasses or bottles away.
12. The use of the outside tables shall cease at 23:00 hours each day.

**Annex 3 – Conditions attached after a hearing by the licensing authority**

None

**Annex 4 – Plans**

See attached

This page is intentionally left blank



Basemap Map

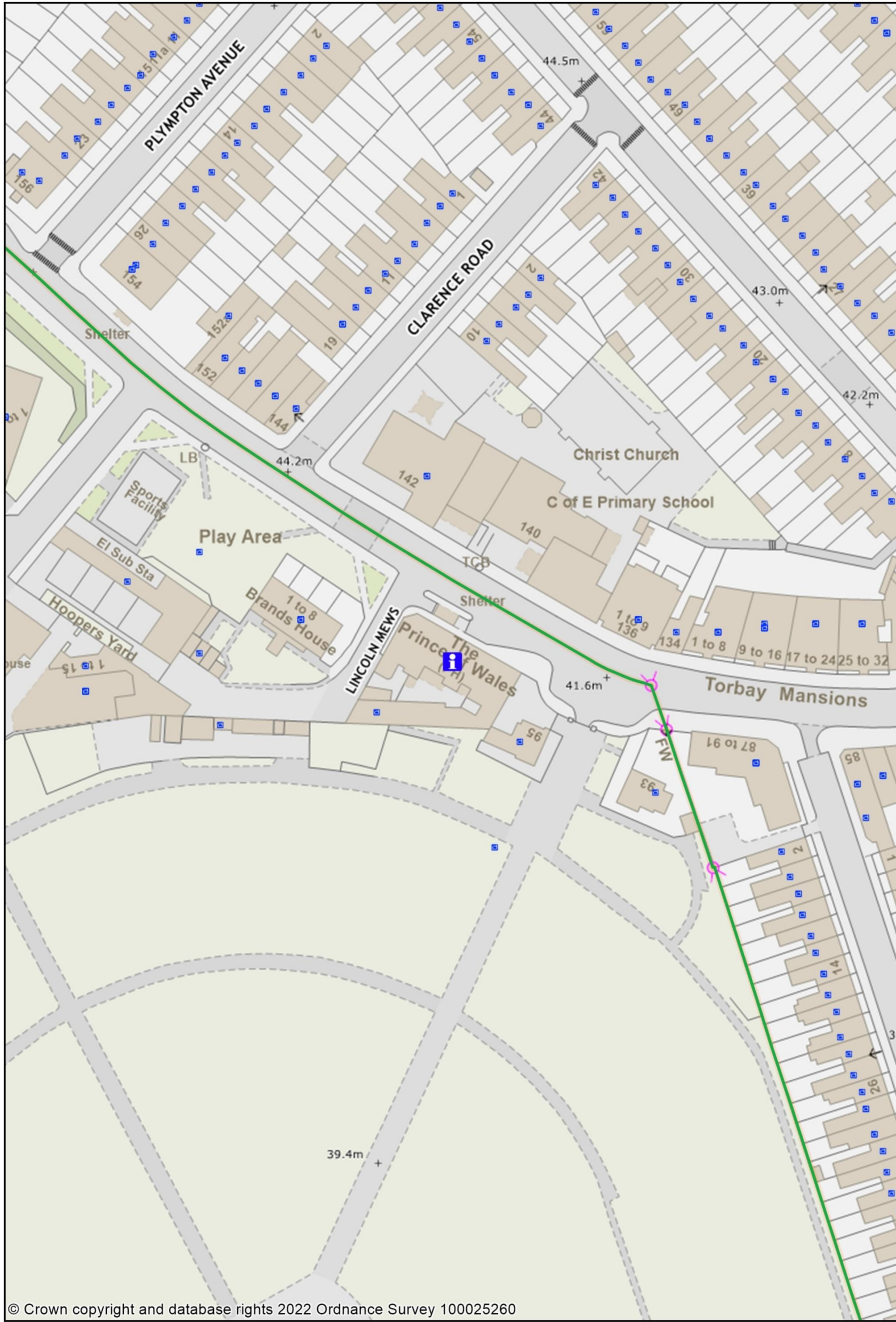

© Crown copyright and database rights 2022 Ordnance Survey 100025260

1:1250

0 0.02 0.04 kilometres



This page is intentionally left blank

Copyright. This drawing and design and all the information contained therein is the sole copyright of Concept IDL and reproduction in any form is forbidden unless permission is obtained in writing.

CONTRACTORS PLEASE NOTE

- 1) Warning, no dimensions to be scaled from this drawing. All contractors to visit the site and be responsible for taking and checking all dimensions relative to this work. The designer must be advised of any discrepancies in writing.
- 2) This drawing must be read in conjunction with the specification / bill of quantities and related drawings. Any structural work must be carried out to the exact specification and requirements of the client's appointed structural engineer, and any amendments must have his express prior written authority.
- 3) All structural work must be inspected at all relevant stages by the structural engineer and the Local Authority's Building Surveyor and comply with their requirements. Any costs and claims for damages, loss of trade, etc. incurred by failing to do so are the sole liability of the contractor.
- 4) Any discrepancies between drawings and/or drawings and specification should be reported to the designer prior to any work commencing.

Date	Revisions	Initials
F 22.08.17	Scale amended	EA
E 10.08.17	External areas noted	EA
D 25.07.17	Rear external area omitted	EA
C 25.07.17	External area omitted	EA
B 20.04.17	Scale amended External area included	EA
A 21.03.17	External area to front red lined	EA

**concept** 

Architects - Interior Design - Project Management

Unit 1, Southfields Centre Park Ltd  
Shilling Business Centre, Sunley Way  
Uxbridge, Middlesex, UB8 3BZ  
Tel: 01895 871 412  
Email: info@conceptidl.co.uk  
Website: www.conceptidl.co.uk  
Facebook: www.facebook.com/conceptidl

Client  
**STAR PUBS & BARS**

Job Title  
**PRINCE OF WALES  
101 WILLESDEN LANE,  
KILBURN,  
LONDON,  
NW6 7ZD.**

Drawing Title  
**LICENSED DRAWING**

Scale: **1:100 @ A3** Drawn By: **APD**

Date: **JULY 16** Checked By:

Drawn By: **2093-60** Rev: **F**

-  - New emergency light fitting connected into existing system to be in accordance with BS5266 Part 1:1999 & BSEN 1839.
-  - New fire alarm sounder locations.
-  - New heat detector, linked to the alarm system, sufficient fittings to be provided to comply with BS5266.
-  - New smoke detector, linked to the alarm system, sufficient fittings to be provided to comply with BS5266.
-  - Existing emergency light fitting to be in accordance with BS5266 Part 1:1999 & BSEN 1839.
-  - Existing illuminated emergency call sign to be in accordance with BS5266 Part 1:1999.

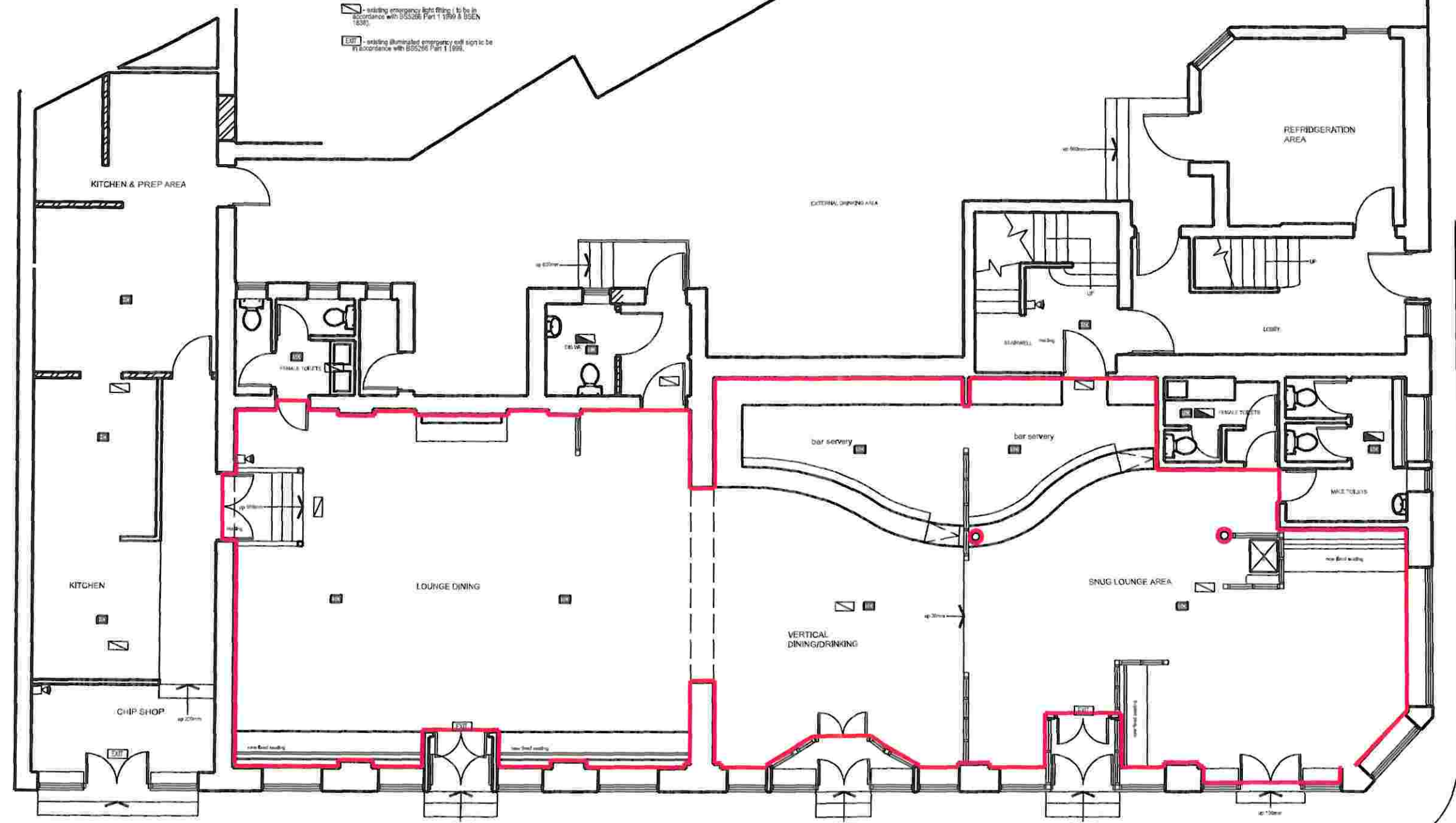

**LEGEND**

 Licensed Area

Fixtures and Fittings

 Games Machine (AWP or SWP)

**NOTE:**  
INTERNAL COVERS -  
LOUNGE DINING - 52  
VERTICAL DINING/DINING - 20  
SNUG LOUNGE - 21.  
TOTAL - 91  
SQUARE METERAGE 164  
(EXCLUDING BAR AREA 28 square metres)  
CHIP SHOP 32 square metres  
LICENSED - 191 square metres



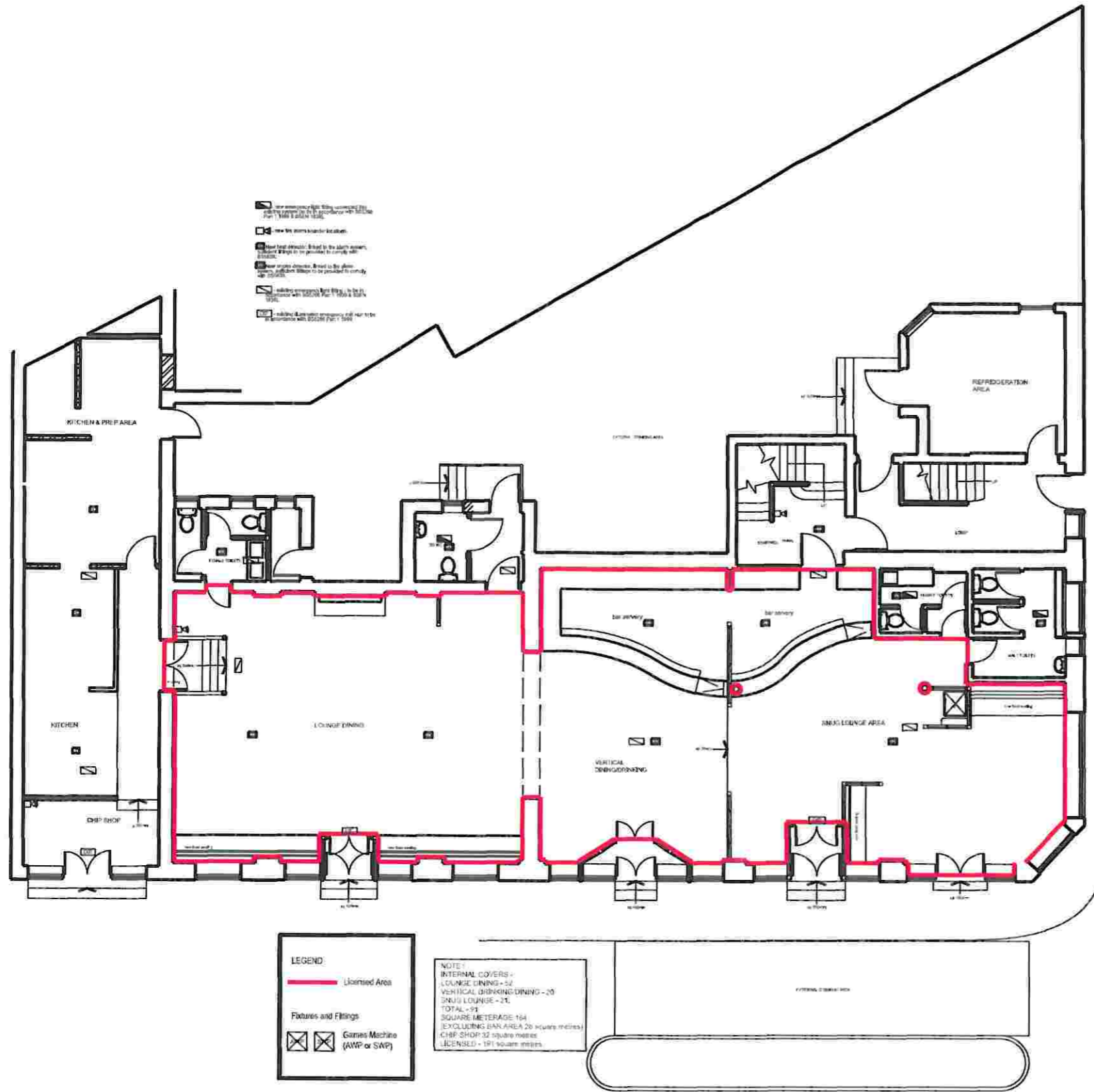

Copyright. This drawing and design and all the information contained therein is the sole copyright of Concept EDL and reproduction in any form is forbidden unless permission is obtained in writing.

**CONTRACTORS PLEASE NOTE**

- 1) Warning, no dimensions to be scaled from this drawing. All contractors to visit the site and be responsible for taking and checking all dimensions relative to this work. The designer must be advised of any discrepancies in writing.
- 2) This drawing must be read in conjunction with the specification / Bill of quantities and related drawings. Any structural work must be carried out to the exact specification and requirements of the client's appointed structural engineer, and any amendments must have his express prior written authority.
- 3) All structural work must be inspected at all relevant stages by the structural engineer and the Local Authority's Building Surveyor and comply with their requirements. Any costs and claims for damages, loss of trade, etc. incurred by failing to do so are the sole liability of the contractor.
- 4) Any discrepancies between drawings and/or drawings and specification, should be reported to the designer prior to any work commencing.

Date	Revisions	Int.
22.08.17	Scale amended	EA
10.08.17	External areas noted	EA
25.07.17	Rear external area omitted	EA
25.07.17	External area omitted	EA
20.04.17	Scale amended External area included	EA
21.03.17	External area to front red lined	EA

**concept**

Architecture - Interior Design - Project Management

Unit 1, The Mill Business Park Ltd  
 The Mill Business Centre, Lurgan, CO. BT67 9JZ  
 Tel: 01708 271179  
 Email: info@conceptedl.co.uk  
 Website: www.conceptedl.co.uk  
 Facebook: www.facebook.com/conceptedl

Client  
**STAR PUBS & BARS**

Job Title  
**PRINCE OF WALES,  
 101 WILLESDEN LANE,  
 KILBURN,  
 LONDON,  
 NW6 7ZD.**

Drawing Title  
**LICENSED DRAWING**

Scale	NOT TO SCALE	Drawn By	APD
Date	JULY 16	Checked By	
Dwg. No.	2093-60	Rev.	F